

**Aluminum Cable Lugs
Standard Type**

For Aluminum Conductors DIN: 48201
and Pre-rounded Sector Shaped Conductors

- Electrolytic high conductivity aluminum

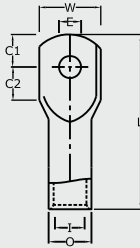

Product Ref.	Conductor Size mm ²	Stud Hole							
		E	W	I	O	C1	C2	L	
AD10-6	10	6.4	11	4.6	7	6.5	7.5	33	
AD16-6	16	6.4	21	6	12	11	13	77	
AD16-8	16	8.4	21			11	13	77	
AD25-6	25	6.4	21	7	12	11	13	77	
AD25-8	25	8.4	21			11	13	77	
AD35-8	35	8.4	23	8	14	11	13	77	
AD35-10	35	10.5	23			11	13	77	
AD50-10	50	10.5	26	10	16	11	13	91	
AD50-12	50	13	26			14	16	91	
AD70-10	70	10.5	27	11.5	18.6	14	16	91	
AD70-12	70	13	27			14	16	91	
AD95-10	95	10.5	27	13.5	22	14	16	91	
AD95-12	95	13	27			14	16	91	
AD120-10	120	10.5	35	15	23	14	16	115	
AD120-12	120	13	35			14	16	115	
AD150-12	150	13	35	16.5	..	14	16	115	
AD150-14	150	15	35			14	16	115	
AD185-12	185	13	42	18.5	28.6	14	20	122	
AD185-16	185	17	42			14	20	122	
AD240-12	240	13	44	21	32	16	22	122	
AD240-16	240	17	44			16	22	122	
AD300-12	300	13	47	22.5	34	16	22	130	
AD300-16	300	17	47			16	22	130	
AD400-16	400	17	51	26	38	18	22	150	